

CURTAIN MOTION DETECTOR **IMDC 200**

DOC. - REF. 214-IMDC
DOC. VERSION : OCTOBER 2015

Product Summary

The IMDC 200 is a wireless, curtain detection, indoor motion detector designed for use in Videofied security systems. The motion detector includes the following features:

- Lithium battery for extended battery life
- Curtain motion coverage lens (12m distance)
- 1m detection width
- Dual tamper function provides detection of both wall and cover tamper
- Transmits check-in/status signal every 8 minutes



Mounting Rules

- > Use proper tools and hardware.
- > Mount indoors in a temperature controlled environment.
- > Mount detector 1,70 meters from the floor.
- > Respect Top and Bottom side of the Motion Viewer.
- > Please install the detector 10 to 20 cm from the wall to be protected. The detection field should be parallel to that wall.
- > The detector should be installed at least 2 meters from the entry point to be protected.
- > Do not aim the detector at heat sources such as lamps, fireplaces, radiators and heating vents.
- > Please ensure that an open door or window will not mask the IMDC detection field.
- > Do not aim detector at moving objects such as curtains, fans or animals.
- > Do not cover the Fresnel lens.

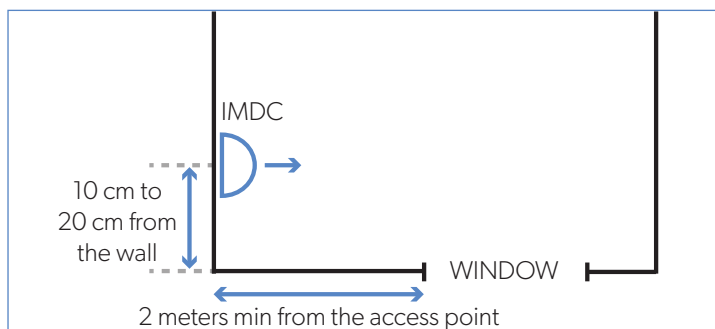

Installation Guidelines

For an easier installation, programming and RF testing should be done to confirm the good communication between the control panel and all system devices before mounting.

Install the detector and other system devices in the following order:

- > Programming / RF Testing: Program detector and all other devices into the control panel and test RF communication at each intended device location to the control panel.
- > Mounting: Mount detector at the tested location.

Sensitivity adjustment

In order to adjust to the site configuration and to the needed detection level, PIR sensitivity can be adjusted by changing the detector name in the panel configuration:

- Add \$8 to the detector name to raise the sensitivity
- Add \$9 to the detector name to strongly raise the sensitivity
- Add \$1 to the detector name to lower the sensitivity
- Add \$2 to the detector name to strongly lower the sensitivity
- Delete the previous setting or add \$0 to the detector name to set the detector to EN50131-2-2 approved sensitivity.

Adjusting sensitivity or mounting height can alter the angle, distance or width of the detection pattern. It is mandatory to perform a detection test after a sensitivity adjustment.

CURTAIN MOTION DETECTOR **IMDC 200**

Detection diagrams (Standard or \$0 sensitivity)

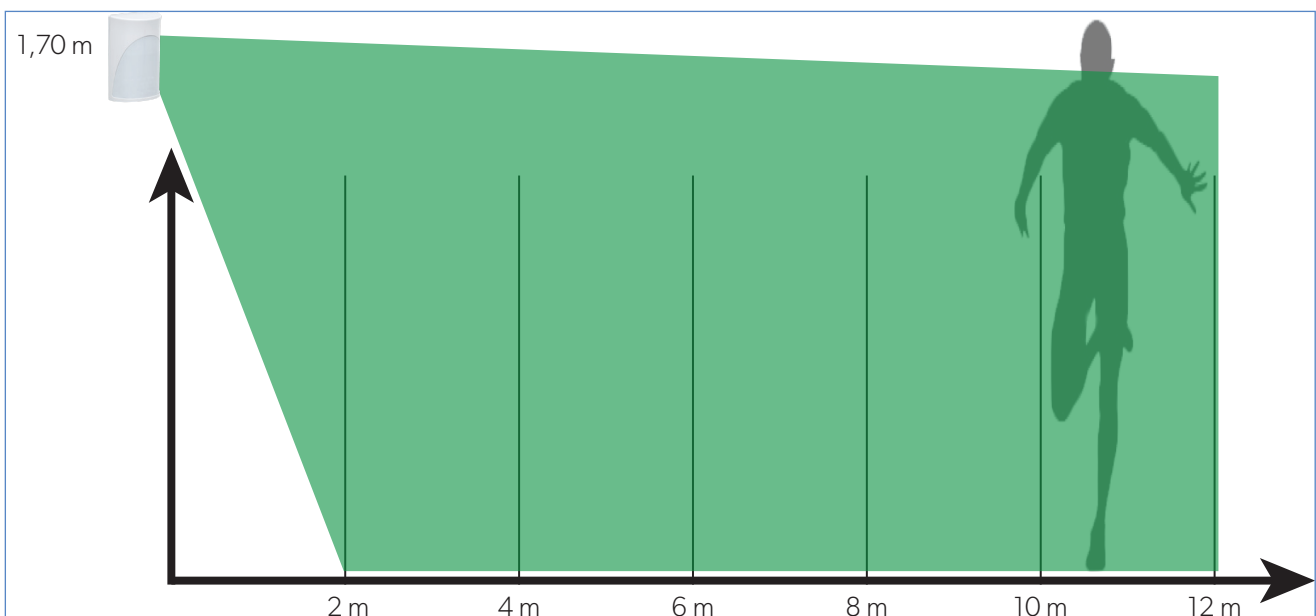
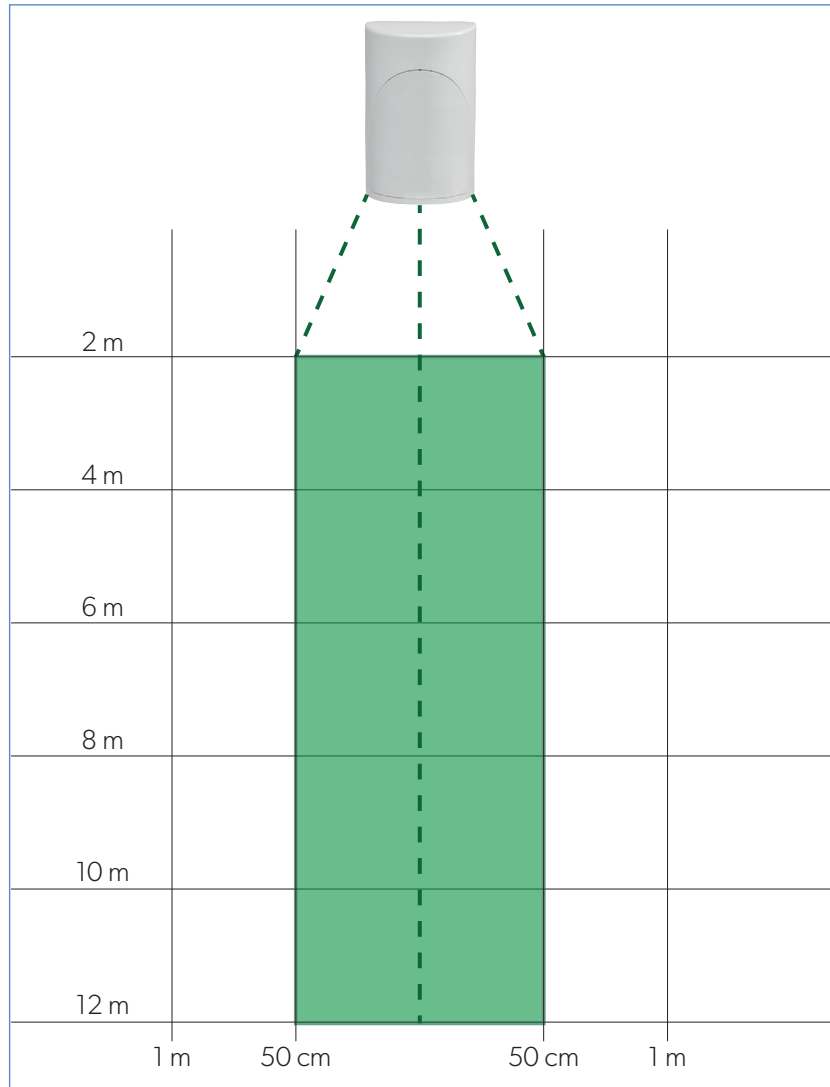

CURTAIN MOTION DETECTOR **IMDC 200**

Programming/RF Testing/Mounting

The following provides summarized steps for device programming, testing, and mounting. For complete details, refer to the control panel installation manual.

1 Loosen bottom screw. ①

Separate base from IMDC. ②

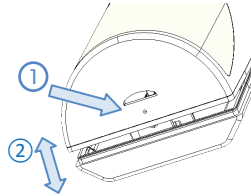

2 Install 1 SAFT LS14500 3.6v batteries, observing correct polarity.

**Check that the LED flashes before staying RED*

3 Put control panel into programming/configuration mode.

4 Using a programmed alphanumeric keypad, proceed through menus until the display shows ADD A NEW DEVICE.

5 Press Yes. The display shows PRESS PROGRAM BUTTON OF DEVICE.

6 Press and release program button on the IMDC using your finger or a screw driver ①. The programming button is located inside the product on the top of the main PCB.

The IMDC LED flashes red ②.

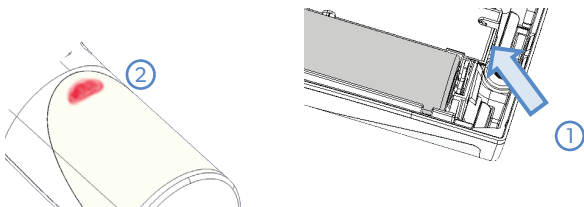

Wait for keypad display to show DETECTOR (1 - 24) PROGRAMMED.

7 Press Yes. The display shows RADIO RANGE TEST? Press YES again. The IMDC LED starts flashing and keypad display shows TEST IN PROGRESS.

8 Move the IMDC to the intended mounting location and make sure you receive a 9/9 indicating good communication with the control panel.

9 Press YES to end the Radio Range Test, then press ESC/NO.

10 The display shows AREA ALLOCATION; AREA: 1. Press either arrow button on the keypad until the desired AREA number appears, then press YES. By default all devices in area 1 will be subject to the entry and exit delays.

11 The display shows NAME + LOCATION:

Enter an appropriate device name (up to 16 characters). The name of the device should describe its intended mounting location or zone. Press YES. The display will show the device number and name for your verification.

12 Mount the IMDC on the wall:

> Follow the mounting rules on page 1

> Drill desired mounting holes in the IMDC base and mark the appropriate mounting holes on the wall.

> Drill pilot holes and install anchors where needed.

> Place base on mounting surface so that the pilot holes line up and secure base with appropriate screws.

> Attach detector to base and secure with screw if required.

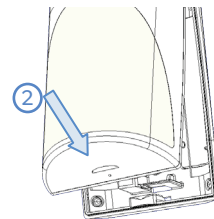

13 Press YES. The display shows FUNCTIONAL DEVICE TEST? Press YES again and verify IMDC operation. The activation of the LED will determine the detection field.

14 Press YES to end the detection verification

15 The display shows ADD A NEW DEVICE? Repeat steps 1-14 for remaining Devices.

16 When finished, exit from configuration mode by pressing and holding the ESC/NO for 5 seconds.

CURTAIN MOTION DETECTOR **IMDC 200**

Security notes / (FR) Notes de sécurité / (DE) Hinweise zur Sicherheit

English

- Remove battery before any maintenance !
- **WARNING**, there is a risk of explosion if a battery is replaced by an incorrect type!
- Observe polarity when setting up the battery!
- Do not throw used batteries! Bring them to your installer or a collection point.

Français

- Retirez les piles avant toute opération de maintenance !
- **Attention !** Il y a un risque d'explosion si l'une des piles utilisées est remplacée par une pile de type incorrect !
- Respectez la polarité lors de la mise en place de la pile !
- Ne jetez pas les piles usagées ! Ramenez-les à votre installateur ou à un point de collecte spécialisé.

Deutsch

- Batterien vor jeglichen Wartungsarbeiten entfernen!
- **Vorsicht**, es besteht Explosionsgefahr, wenn eine Batterie durch eine Batterie falschen Typs ersetzt wird!
- Achten Sie beim Einsetzen der Batterie auf die Polung!
- Entsorgen Sie Batterie nicht im normalen Haushaltsmüll! Bringen Sie Ihre verbrauchten Batterien zu den öffentlichen Sammelstellen.

ELECTRICAL PROPERTIES

Panel compatibility	W, XL, XT, XV, Visio and their variants
Power requirements	Type C - (1x) 3,6 V LS14500 Lithium battery
Nominal voltage	3,6 V
Low battery limit	2,7 V
Battery life (estimated)	Up to 4 years
Current Consumption	
Standby (1h average)	40 µA
Max	37 mA

RADIO PROPERTIES

S2View® RF Technology	
Radio type	Spread spectrum bidirectional RF
Operating frequency	<ul style="list-style-type: none"> • 868MHz - IMDC 200 (Europe, Africa, Asia)
Transmission security	AES algorithm encryption
Supervision	Radio, batteries, tamper
Radio antenna	Integrated

DETECTION PROPERTIES

Infrared detection specifications	
Technology	Passive infrared DSP
Type	Dual element
Detection lens	Fresnel
Detection angle	Curtain (5° max)
Detection range	Up to 12m
Tamper	
	Wall and cover tamper

BOX

Physical properties	
Material	ABS—ULV0
Dimensions	51.2 x 80.9 x 36.8mm
Weight	58 g (sans pile)
Environnemental properties	
Operating temperature	-10°/+55° C
Maximum relative humidity	75%, non-condensing
Protection marking	IP30/IK04
Installation / Mounting	
Mounting height	1,70 m
Mounting on flat wall	2 screws
Closing of the casing	Closing by clip and screw if required by local legislation

STANDARD AND CERTIFICATIONS



NF&A2P – Grade 2 – suivant le référentiel **NF324-H58**

Matériels de sécurité électronique, détection d'intrusion

DETECTEUR DE MOUVEMENT A INFRAROUGE PASSIF

Marque commerciale	Videofied
Référence produits	IMDC200
N° de certification	2603200009
NF EN50131-2-2 Grade 2	2008
NF EN50130-4	2011
NF EN50130-5 Environment class II	2011

Organisme certificateur :

CNPP Cert.

Route de La Chapelle Réanville CS22265

F—27950 SAINT MARCEL

Tel : +33(0)2.32.53.63.63

Fax: +33(0)2.32.53.64.46

Sites Internet : www.cnpp.com

Email : certification@cnpp.com

Organisme certificateur :

AFNOR Certification

11, rue François de Pressensé

93571 Saint Denis La Plaine Cedex

Tel : +33(0)1.41.62.80.00

Fax: +33(0)1.49.17.90.00

Sites Internet : www.marque-nf.com

E-mail : certification@afnor.org



This symbol on the product or on its packaging indicates that this product should not be treated as household waste. It must be handed over to the applicable collection point for the recycling of electrical and electronic equipment. By ensuring this product is disposed of correctly, you will help prevent potential negative consequences for the environment and human health. The recycling of materials will help to conserve natural resources. For more information about recycling of this product, please contact your local municipality, your waste disposal service or the company that installed the product.

© 2013 RSI Video Technologies Videofied® and MotionViewer® are Registered Trademark of RSI Video Technologies. Specifications subject to change without notice.

EMEA SALES

23, avenue du Général Leclerc

92340 BOURG-LA-REINE

FRANCE

E-Mail : emeasales@rsivideotech.com

North American Headquarters

1375 Willow Lake Blvd, Suite 103

Vadnais Heights, MN 55110

USA

E-Mail : usasales@rsivideotech.com

